

Gearbox Mounting Positions

Last updated 1 year ago

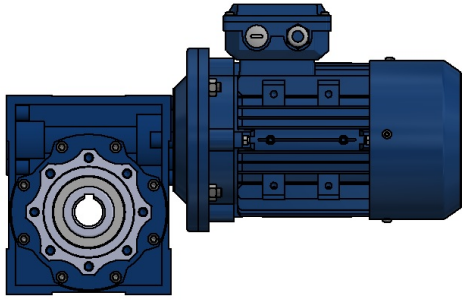

B3

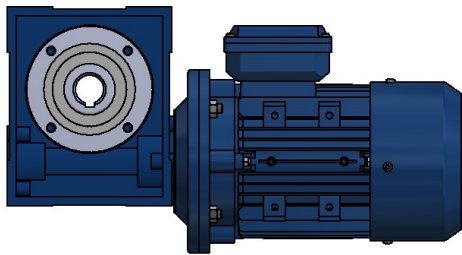

B8

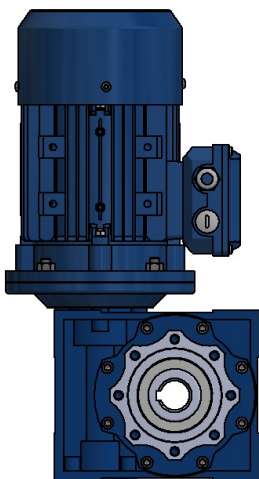

V5

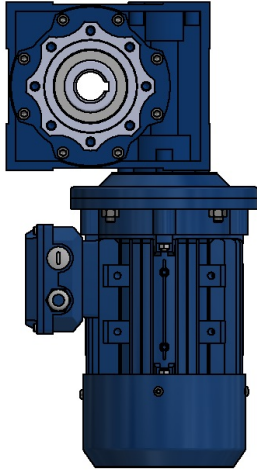

V6

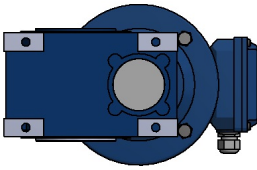

B6

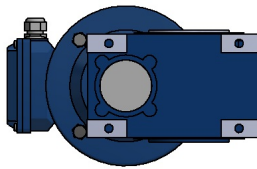

B7

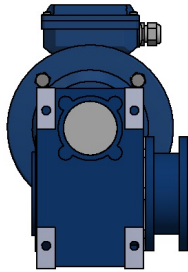

F1, Left (Output Flange)

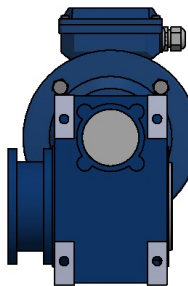

F1, Right (Output Flange)

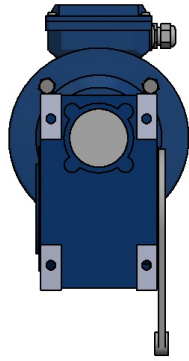

B Left (Torque Arm)

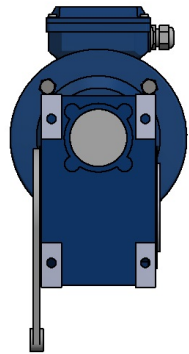

B Right (Torque Arm)

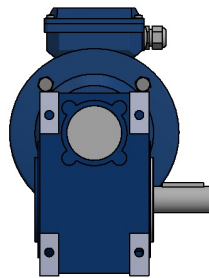

A1 Left (Output Shaft)

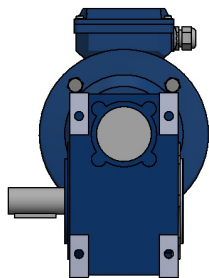

A1 Right (Output Shaft)

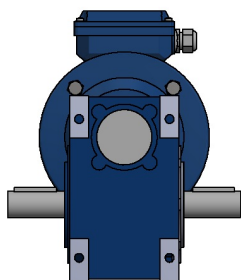

A2 (Output Shaft)

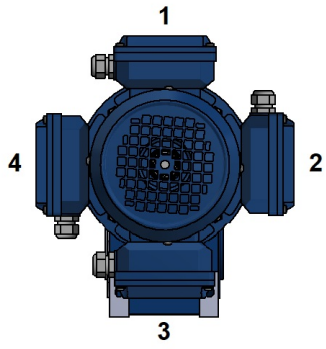

Position of motor terminal box